

- |           |  |
|-----------|--|
| <b>DE</b> | <b>Bedienungsanleitung</b><br>Handsender HS 5 BiSecur          |
| <b>EN</b> | <b>Operating instructions</b><br>Hand transmitter HS 5 BiSecur |
| <b>FR</b> | <b>Instructions d'utilisation</b><br>Emetteur HS 5 BiSecur     |
| <b>NL</b> | <b>Bedieningshandleiding</b><br>Handzender HS 5 BiSecur        |
| <b>IT</b> | <b>Istruzioni d'uso</b><br>Telecomando HS 5 BiSecur            |
| <b>ES</b> | <b>Instrucciones de servicio</b><br>Emisor manual HS 5 BiSecur |
| <b>PT</b> | <b>Instruções de funcionamento</b><br>Emissor HS 5 BiSecur     |

# Contents

<b>1</b>	<b>About these instructions .....</b>	<b>18</b>
<b>2</b>	<b>Safety instructions .....</b>	<b>18</b>
2.1	Intended use .....	18
2.2	Safety instructions for operating the hand transmitter .....	19
<b>3</b>	<b>Scope of delivery .....</b>	<b>20</b>
<b>4</b>	<b>Description of the hand transmitter HS 5 BiSecur .....</b>	<b>21</b>
<b>5</b>	<b>Initial start-up .....</b>	<b>21</b>
5.1	Insert battery .....	21
<b>6</b>	<b>Operation .....</b>	<b>22</b>
<b>7</b>	<b>Learning and inheriting / transmitting a radio code .....</b>	<b>23</b>
7.1	Teaching in a radio code .....	23
7.2	Mixed operation / BiSecur and fixed code 868 MHz.....	24
<b>8</b>	<b>Querying the door position.....</b>	<b>24</b>
8.1	Manual door position query .....	24
8.2	Automatic feedback of the door position after manual query .....	26
<b>9</b>	<b>Reset .....</b>	<b>27</b>
9.1	Set the fixed code 868 MHz.....	27
<b>10</b>	<b>LED display .....</b>	<b>28</b>
<b>11</b>	<b>Cleaning .....</b>	<b>29</b>
<b>12</b>	<b>Disposal .....</b>	<b>30</b>
<b>13</b>	<b>Technical data .....</b>	<b>30</b>

Dissemination as well as duplication of this document and the use and communication of its content are prohibited unless explicitly permitted. Non-compliance will result in damage compensation obligations. All rights reserved in the event of patent, utility model or design model registration. Subject to changes.

Dear Customer,

We thank you for choosing a quality product from our company.

## **1 About these instructions**

Read through all of the instructions carefully, as they contain important information about the product. Pay attention to and follow the instructions provided, particularly the safety instructions and warnings.

Further information about handling the hand transmitter can be found on the Internet at **[www.hoermann.com](http://www.hoermann.com)**

Please keep these instructions in a safe place and make sure that they are available to all users at all times.

## **2 Safety instructions**

### **2.1 Intended use**

The hand transmitter HS 5 BiSecur is a bi-directional transmitter for operators and their accessories. It can be operated with both the BiSecur radio and the fixed code 868 MHz.

Other types of application are prohibited. The manufacturer is not liable for damage caused by improper use or incorrect operation.

## 2.2 Safety instructions for operating the hand transmitter



### WARNING

#### **Danger of injury during door travel**

Persons may be injured by door travel if the hand transmitter is actuated.

- ▶ Make sure that the hand transmitters are kept away from children and can only be used by people who have been instructed on how the remote-control door functions!
- ▶ If the door has only one safety device, only operate the hand transmitter if you are within sight of the door!
- ▶ Only drive or pass through remote control door systems if the door is in the Open end-of-travel position!
- ▶ Never stand in the door's area of travel.
- ▶ Please note that unwanted door travel may occur if a hand transmitter button is accidentally pressed (e.g. if stored in a pocket/handbag).



### CAUTION

#### **Danger of injuries due to unintended door travel**

- ▶ See warning in section 7

**ATTENTION****Malfunction due to environmental influences**

Non-compliance with these instructions can impair function!

Protect the hand transmitter from the following conditions:

- Direct sunlight (permissible ambient temperature:  $-20^{\circ}\text{C}$  to  $+60^{\circ}\text{C}$ )
- Moisture
- Dust

**NOTES:**

- If there is no separate garage entrance, perform all programming changes and extensions of radio systems from inside the garage.
- After programming or extending the radio system, perform a function test.
- Only use original components when putting the radio system into service or extending it.
- Local conditions may affect the range of the radio system.
- When used at the same time, GSM 900 mobile phones can affect the range.

**3 Scope of delivery**

- Hand transmitter HS 5 BiSecur
- 1x1.5 V battery, type: AAA (LR03)
- Battery lid
- Operating instructions

## 4 Description of the hand transmitter HS 5 BiSecur

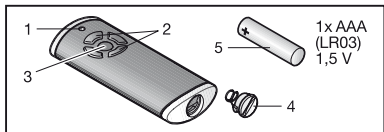

- 1 LED, multicolour
- 2 Hand transmitter buttons
- 3 Door position inquiry button
- 4 Battery lid
- 5 Battery

## 5 Initial start-up

After inserting the battery, the hand transmitter HS 5 BiSecur is ready for operation.

### 5.1 Insert battery

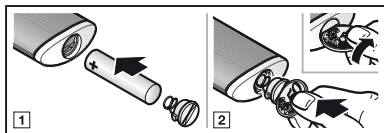

**ATTENTION****Destruction of the hand transmitter by leaking batteries**

Batteries can leak and destroy the hand transmitter.

- ▶ Remove the battery from the hand transmitter if it is out of use for a long period of time.

## 6 Operation

**NOTE:**

If the radio code for the taught-in hand transmitter was copied from another hand transmitter, the hand transmitter button must be pressed a second time during initial start-up.

Each hand transmitter button is assigned to a radio code. Press the button of the hand transmitter whose radio code you want to transmit.

- The radio code is transmitted and the LED is illuminated blue for 2 seconds.

**NOTE:**

If the battery is almost empty, the LED flashes red twice

- before transmitting the radio code.
  - ▶ The battery **should be** replaced soon.
- and the radio code is not transmitted.
  - ▶ The battery **must be** replaced immediately.

## 7 Learning and inheriting / transmitting a radio code



### CAUTION

#### Danger of injuries due to unintended door travel

Unintended door travel may occur while teaching in the radio system.

- ▶ Make sure no persons or objects are in the door's area of travel when teaching in the radio system.

### 7.1 Teaching in a radio code

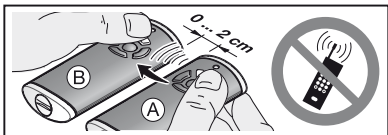

1. Press the hand transmitter button on hand transmitter **A**, whose radio code is to be inherited, and keep it pressed.
  - The radio code is transmitted and the LED is illuminated blue for 2 seconds then goes out.
  - After 5 seconds, the LED alternates flashing in red and blue; the radio code is transmitted.
2. Place hand transmitter **B** into which you want to teach in the radio code, to its left.
3. Press the hand transmitter button to which the new radio code is to be allocated, and keep it pressed.
  - The LED will flash slowly in blue.



- If the radio code is recognised, the LED flashes quickly in blue.
- After 2 seconds, the LED goes out.

**NOTE:**

You have 15 seconds to inherit / transmit the code. The process must be repeated if the radio code is not successfully inherited / transmitted within this time.

**7.2 Mixed operation / BiSecur and fixed code 868 MHz**

If the BiSecur radio has been set, mixed operation is possible, i.e. existing hand transmitters with an 868 MHz fixed code (grey hand transmitters with blue buttons or the device designation HSD2-868) can be taught in from the BiSecur hand transmitter.

**8 Querying the door position****8.1 Manual door position query**

A query of the current door position (Open / Close) is possible with this hand transmitter. For this purpose, the operator must be equipped with a bi-directional radio module and be within the range of the hand transmitter.

**NOTE:**

If a hand transmission button is pressed that does not actuate a bi-directional radio module, the door position query is aborted.

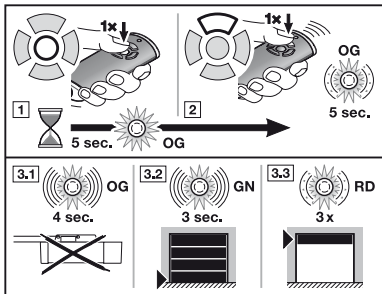

1. Press the door position query button.
  - The LED is illuminated orange for 5 seconds.
2. Within this period of time, press the hand transmitter button of the door system whose position you want to query.
  - The LED slowly flashes in orange for 5 seconds.
3. Depending on the position of the door, the respective feedback will be sent.
  - 3.1 The LED flashes rapidly in orange for 4 seconds.
    - The operator is out of reach.
  - 3.2 The LED flashes rapidly in green for 3 seconds.
    - Position: door is closed.
  - 3.3 The LED flashes slowly 3 times in red.
    - Position: door is not closed.

A new door position query is only possible after the LED stops flashing.

## 8.2 Automatic feedback of the door position after manual query



### WARNING

#### Danger of injury during door travel

- ▶ See warning in section 2.2

If the same hand transmitter button is pressed again within 5 seconds after the manual door position query, you will receive automatic feedback on the door position as soon as the door has reached an end-of-travel position.

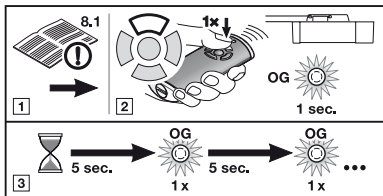

1. Perform a manual door position query, see section 8.1.
2. Press the hand transmitter button **again** as described in section 8.1, step 2.
  - The radio code is transmitted and the LED is illuminated briefly in orange.
3. The position of the door will be queried every 5 seconds; the LED is illuminated briefly in orange.

#### NOTE:

The repeated pressing of the hand transmitter button activates door travel if the door is not in motion.

4. If the position of the operator is known, it is automatically transmitted back.

## 9 Reset

Each hand transmitter button is assigned to a new radio code by means of the following steps.

1. Open the battery lid and remove the battery for 10 seconds.
2. Press a hand transmitter button and keep it pressed.
3. Insert the battery and close the battery lid.
  - The LED slowly flashes in blue for 4 seconds.
  - The LED flashes rapidly in blue for 2 seconds.
  - The LED is illuminated blue for a long time.
4. Release the hand transmitter button.  
**All radio codes are newly assigned.**

### NOTE:

If the hand transmitter button is released prematurely, no new radio codes are assigned.

### 9.1 Set the fixed code 868 MHz

If immediately following the device reset, the hand transmitter button remains pressed, the fixed code 868 MHz will be activated.

- The LED slowly flashes in red for 4 seconds.
- The LED flashes rapidly in red for 2 seconds.
- The LED is illuminated red for a long time.

**All radio codes are newly assigned.**

### NOTE:

If the hand transmitter button is released prematurely, the BiSecur radio will remain active.

Further information about operating the hand transmitter with the fixed code 868 MHz can be found on the Internet at [www.hoermann.com](http://www.hoermann.com)

## 10 LED display

### Blue (BU)

Condition	Function
Illuminated for 2 seconds	A radio code is being transmitted
Flashes slowly	Hand transmitter is in the learn mode
Flashes quickly after slow flashing	A valid radio code was detected during the learning run
Flashes slowly for 4 seconds Flashes quickly for 2 seconds Illuminated long	Device reset is being performed or completed

### Red (RD)

Condition	Function
Flashes 2x	The battery is almost empty
Flashes slowly 3x	Position: door is not closed

### Blue (BU) and Red (RD)

Condition	Function
Flashing alternately	Hand transmitter is in inherit / transmit mode

**Orange (OG)**

Condition	Function
Is illuminated for 5 seconds	The door position query has been activated
Flashes slowly for 5 seconds	The position is queried
Flashes quickly for 4 seconds	The operator is out of reach
Illuminated briefly	The position is queried every 5 s

**Green (GN)**

Condition	Function
Flashes quickly for 3 seconds	Position: door is closed

**11 Cleaning****ATTENTION****Damaging the hand transmitter by faulty cleaning**

Cleaning the hand transmitter with unsuitable cleaning agents can damage the hand transmitter housing as well as the hand transmitter buttons.

- ▶ Clean the hand transmitter with a clean, soft, damp cloth.

**NOTE:**

White hand transmitter buttons can change their colour when used regularly over an extended period of time, if they come in contact with cosmetic products (e.g. hand cream).

## 12 Disposal



Electrical and electronic devices, as well as batteries, may not be disposed of in household rubbish, but must be returned to the appropriate recycling facilities.



## 13 Technical data

Type	Hand transmitter HS 5 BiSecur
Frequency	868 MHz
Power supply	1x 1.5 V battery, type: AAA (LR03)
Perm. ambient temperature	-20°C to +60°C
Protection category	IP 20